

## LED Tube MY-T506C

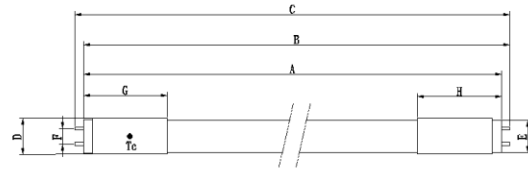

My lumens tube is good replacement of 0.6M 14W traditional fluorescent as saving 43% electricity. As the same time, it provides pure and high uniformity lighting performance with-out flicker, no glare. Offer customer best experientment.



A	B	C	D	E	F	G	H
549	560	571	18	16	5	40	48

Cap-Base	G5
Size:	φ18*L549mm
SDCM	5
Power	8W
Input	220-240Vac 50/60HZ
Driver	Internal
PF	>0.9
Dimmerable	No
Rated Lifetime	>50000hrs B50L70
Switching Cycle	50000 times
Start Time	<0.5S
IP Grade	II
IP	IP44
Material	Glass
Weight	72g
Ambient temperature	- 25-55°C
Storage temperature	- 30-65°C
Tc	- 10-65°C
Humidity	0%-95%
Energy Efficiency Label (EEL)	A++
Test	CE, ENEC is pending

Model No.	CCT	CRI	Flux	Beam Angel	Cover	Power	Energy Efficiency Label
MY-T50640808102C	4000K	80+	1050lm	180°	Clear	8W	A++
MY-T50630808102C	3000K	80+	1050lm	180°	Clear	8W	A++

**Installation Instructions for MY LUMENS TUBE**

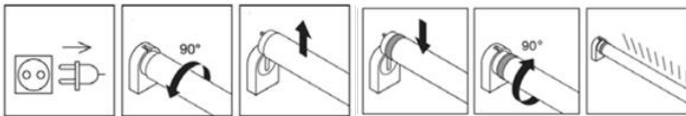

- Always switch off the power supply prior to installation .
- Turn the conventional lamp 90° (1) and take it out of the socket carefully (2).
- Insert MY LUMENS LED Tube into socket (5) and locate into position by turning 90° (6).
- Switch on the power supply and Check light emission direction (7).

**Package: 1.MY LED Tube 2.Installation**

**Package Type**

**A**

**B**

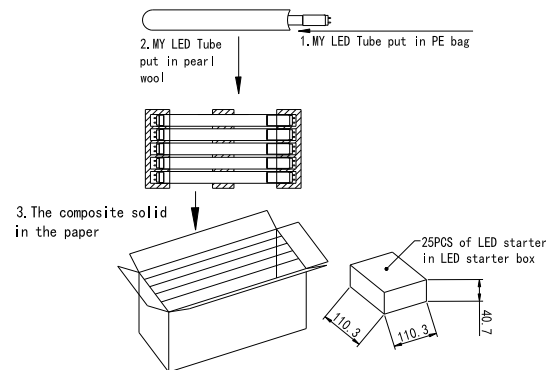
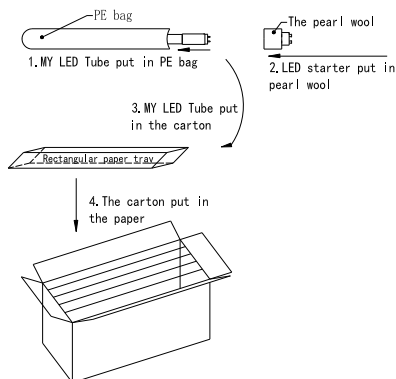

**20PCS/Box L1218\*W153\*H800 2.76KG**